

D-NAMIC

92 Shore A
+90°C
-40°C

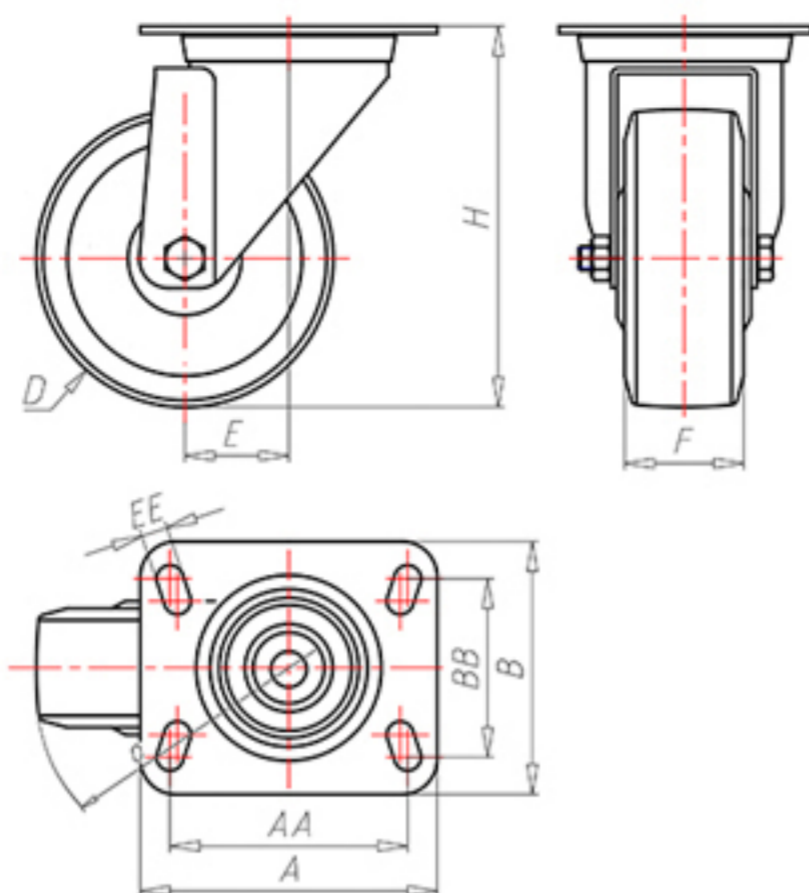

	D	100
	F	33
	H	128
	AxB	100x85
	AAxBB	80x60
	EE	9
	E	42
	O	92
	LC	220



Code for plain bore wheel

XNGZ10045



Code for wheel with roller bearing

XNGZ10045R



Code for wheel with double sealed ball bearing

XNGZ100C



Code for wheel with double sealed Inox ball bearing

-

