

D-NAMIC

92 Shore A  
+90°C  
-40°C

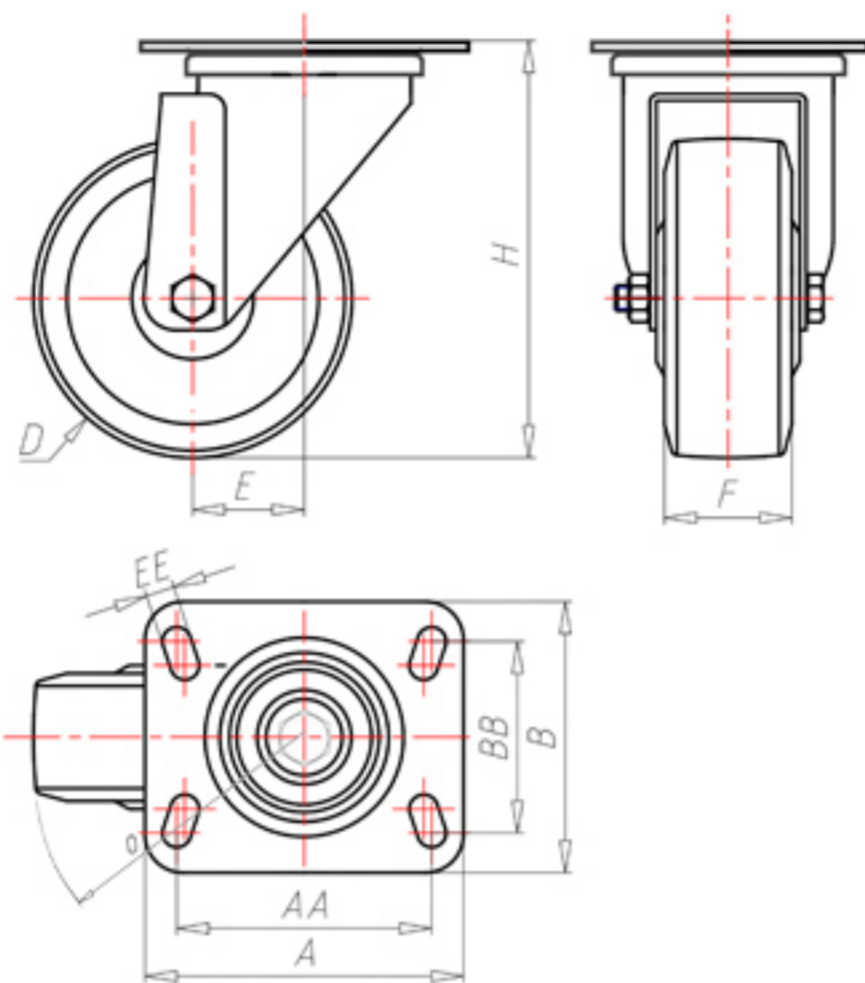

	D	80
	F	33
	H	110
	AxB	100x85
	AAxBB	80x60
	EE	9
	E	40
	O	82
	LC	210



Code for plain bore wheel

XNGZ8040P



Code for wheel with roller bearing

XNGZ8040PR



Code for wheel with double sealed ball bearing

XNGZ8040PC



Code for wheel with double sealed Inox ball bearing

-

