

D-FLEX

82 Shore A
+90°C
-40°C

INOX

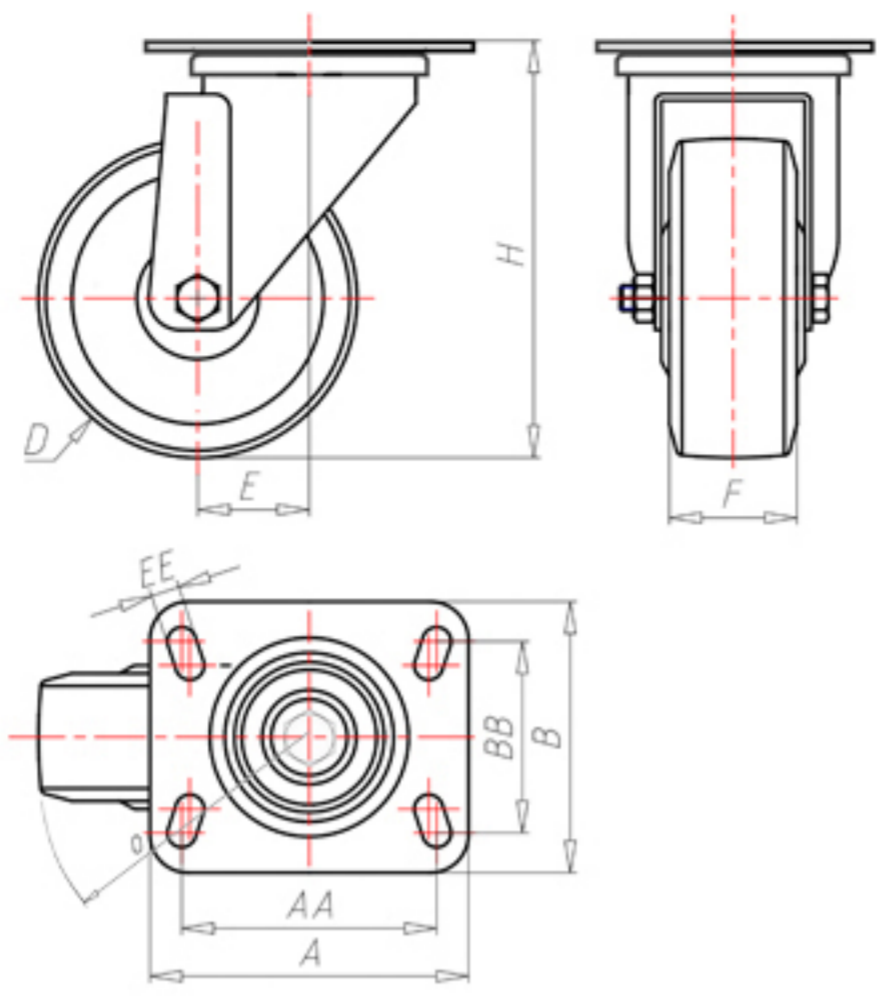

	D	125
	F	35
	H	158
	AxB	100x85
	AAxBB	80x60
	EE	9
	E	44
	O	107
	LC	260



Code for plain bore wheel

XSGX12545P

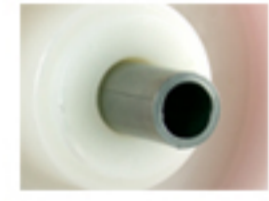

Code for wheel with Inox roller bearing

XSGX12545PRX



Code for wheel with double sealed ball bearing

XSGX125PC



Code for wheel with double sealed Inox ball bearing

XSGX125PCX

