

D-FLEX

82 Shore A
+90°C
-40°C

INOX

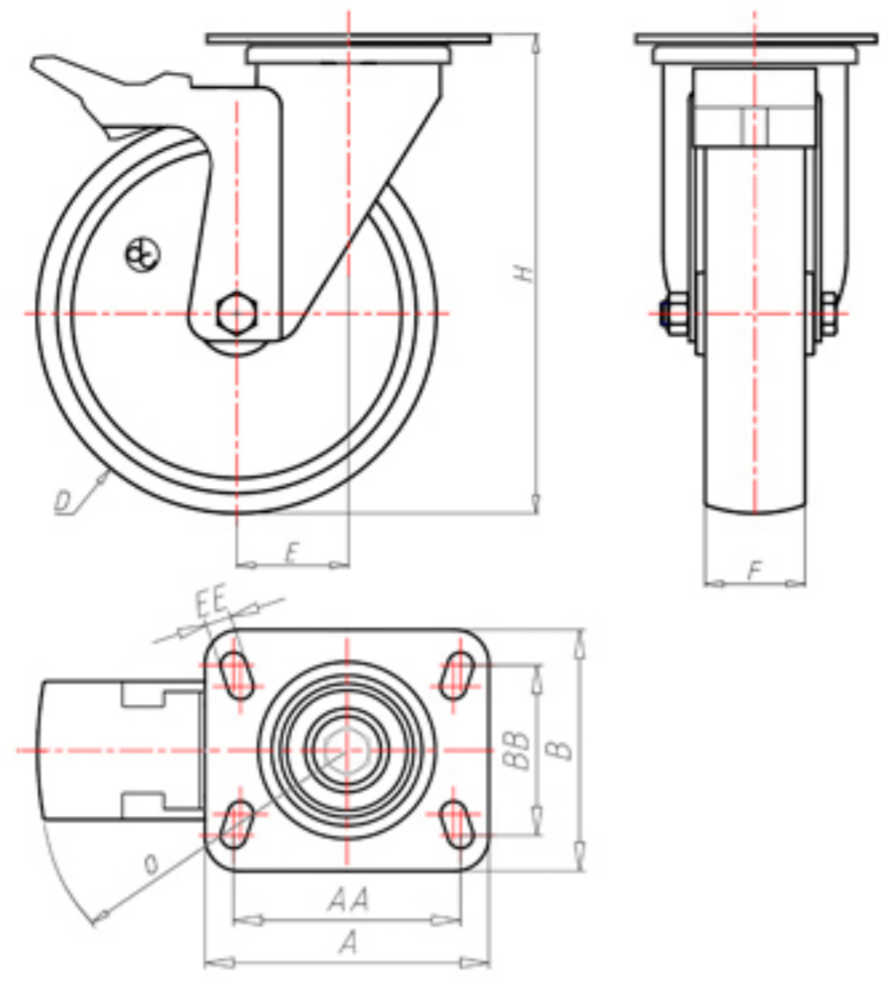

	D	125
	F	35
	H	158
	AxB	100x85
	AAxBB	80x60
	EE	9
	E	44
	O	124
	LC	260



Code for plain bore wheel

XSGX12545PFA

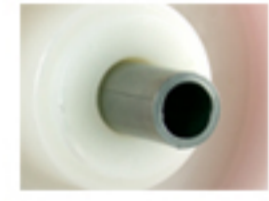

Code for wheel with Inox roller bearing

XSGX12545PRXFA



Code for wheel with double sealed ball bearing

XSGX125PCFA



Code for wheel with double sealed Inox ball bearing

XSGX125PCXFA

