

D-FLEX

82 Shore A
+90°C
-40°C

INOX

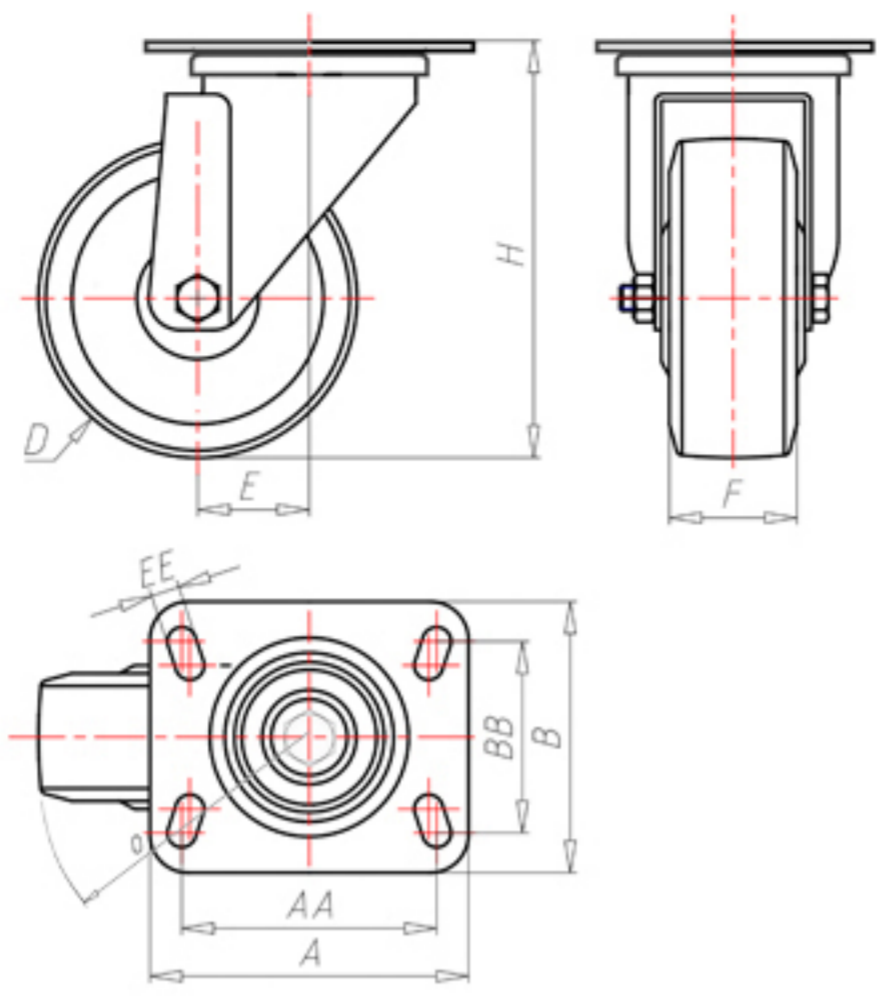

	D	80
	F	33
	H	110
	AxB	100x85
	AAxBB	80x60
	EE	9
	E	40
	O	82
	LC	210



Code for plain bore wheel

XSGX8045P

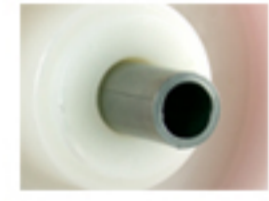

Code for wheel with Inox roller bearing

XSGX8045PRX



Code for wheel with double sealed ball bearing

XSGX80PC



Code for wheel with double sealed Inox ball bearing

XSGX80PCX

